

# GUBB, GUBBD and GUBBM Cast Junction Boxes

## Explosionproof, Dust-Ignitionproof

UNILETS™ for Use with Threaded Metal Conduit.

### NEC/CEC — GUBB:

Class I, Division 1 and 2, Groups B, C, D  
Class II, Division 1 and 2, Groups E, F, G  
Class III  
NEMA 3, 3R, 4, 7BCD, 9EFG

### NEC/CEC — GUBBD:

Class I, Division 1 and 2, Group D  
Class II, Division 1 and 2, Groups E, F, G  
Class III  
NEMA 3, 3R, 4

### NEC/CEC — GUBBM:

Class I, Division 1 and 2, Group D  
Class II, Division 1 and 2, Groups E, F, G  
Class III  
NEMA 3, 3R, 4

## Applications

- Explosionproof and dust-ignitionproof, for use in classified locations.
- Corrosion-resistant: ideal indoors or outdoors.
- Junction or pull box for pulling and splicing of wires and as an enclosure for electrical devices.
- Ideal where number and size of conductors require a junction box with additional space.

## Features

- All GUBB/GUBBD/GUBBM Series Boxes
  - Provided with mounting lugs.
  - Furnished with covers.
  - All conduit hubs and openings provide a minimum of five full threads to meet UL requirements.
  - Accurately tapped, tapered conduit threads provide tight, rigid joints and ground continuity.
- GUBB Series
  - Wide selection of sizes and locations for drilled and tapped conduit openings.
  - Suitable for use as an enclosure for relays, instrument and other control apparatus in classified locations.
  - Available in high tensile strength malleable iron or copperfree aluminum bodies.
  - Provided with mounting lugs.
  - O-rings standard for forms 1, 2 and 3 to provide raintight fit.
- GUBBD Series (Dome and Plate)
  - GUBB junction boxes with dome cover and mounting plate provide flexibility for a wide variety of applications.
  - Ideal for housing relays, contactors, terminal blocks and other classified area applications.
  - Mounting plate can be drilled to accommodate a variety of devices.
  - Dome cover has nominal depth of 152 mm (6") or 431 mm (17"), depending upon box selected. Provides significant increase in cubic inch capacity.
  - O-rings standard to provide raintight fit.
  - Provided with mounting lugs.
- GUBBM Series (Instrument)
  - GUBBM junction boxes serve as an enclosure for meters, gauges and similar devices.
  - Complete with round, explosionproof glass window cover. Permits direct reading of enclosed instrument.
  - Furnished with one 3/4" drilled and tapped entry.
  - Mounted bosses provided in back of GUBBM can be drilled and tapped for fastening of instrument mounting bracket.
  - O-rings standard to provide raintight fit.
  - Provided with mounting lugs.

## Standard Materials

- GUBB bodies: copperfree (4/10 of 1% max.) aluminum or malleable iron bodies
- GUBBD bodies: malleable iron bodies
- GUBB, GUBBD covers: copperfree (4/10 of 1% max.) aluminum
- GUBBM bodies: copperfree (4/10 of 1% max.) aluminum
- GUBBM covers: copperfree (4/10 of 1% max.) aluminum and glass
- O-ring: neoprene



GUBB

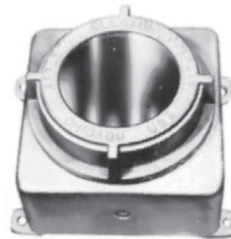

GUBBM  
Instrument Box



GUBBD  
Dome Cover

## Standard Finishes

- GUBB malleable iron bodies: triple-coat — (1) zinc electroplate, (2) chromate, and (3) epoxy powder coat.
- GUBB aluminum covers and aluminum bodies: epoxy powder coat

## Options

- GUBB
  - Less cover, add suffix —**LC**.
  - Terminal blocks. Information provided upon request.
- Instrument mounting plate and bracket for GUBBM. Information provided upon request (submit complete dimensions of instrument to be used).

## NEC/CEC Certifications and Compliances

- UL Standard: UL 886 (UL 1203)
- UL Listed: E85310
- CSA Standard: C22.2 No. 25, C22.2 No. 30
- CSA Certified: 025875

# GUBB Blank Body Cast Junction Boxes

## Explosionproof, Dust-Ignitionproof

Drilling and tapping ordering information.

### NEC/CEC:

Class I, Division 1 and 2, Groups B, C, D  
 Class II, Division 1 and 2, Groups E, F, G  
 Class III  
 NEMA 3, 3R, 4, 7BCD, 9EFG

Determine catalog number as follows: (1) select GUBB junction box catalog number; (2) select "Conduit Opening Arrangement Diagram" number; and (3) select symbols that represent conduit opening sizes from "Symbol Table."

Where no opening is required, the symbol 0 must be inserted. Add suffix for other Optional Features. The various divisions of the complete catalog number should be separated by dashes.

### Example

The junction box selected is GUBB-33 and the "Conduit Opening Arrangement" is diagram #1. Opening "a" is to be 3/4"; "b", no opening required; "c", 2"; and "d", 1-1/4".

In this example, the complete catalog number is

**GUBB-33-1-BOFD**

Standard Conduit Opening Arrangement Diagrams

Opening "a" is always TOP of box

### Standard Conduit Opening Arrangement Diagrams

Opening "a" is always TOP of box. All conduit openings will be located in centerline of walls and evenly spaced unless otherwise specified.

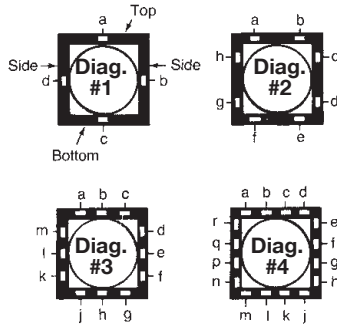

If a "Standard Conduit Opening Arrangement" is not suitable for the application, or when openings are to be more accurately spaced, submit sketch, locating openings (1) from centerlines of box and (2) from outside back of box (or from mounting lug surface if lugs are supplied).

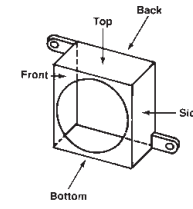

**GUBB-11,22**  
(also GUBB-11A, 22A)

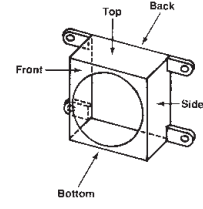

**GUBB-33**  
(also GUBB-33A)

### Symbol Table

Drilling and Tapping (Five Threads Minimum)

| Conduit Size Inches | Symbol | Conduit Size Inches | Symbol |
|---------------------|--------|---------------------|--------|
| 0                   | Blank  | -                   | -      |
| 1/2                 | A      | 2                   | F      |
| 3/4                 | B      | 2-1/2               | G      |
| 1                   | C      | 3                   | H      |
| 1-1/4               | D      | 3-1/2               | J      |
| 1-1/2               | E      | 4                   | K      |

### Minimum Recommended Spacing Between Conduit Openings

Allowance made for clearance over bushings. When unions or seals are used, additional space must be allowed.

Table shows minimum distances between conduit-opening centerlines in various size combinations. For example, if 1-1/2" and 3/4" openings are to be drilled and tapped into one side of box, the minimum spacing between centerlines would be 2.13".

| Conduit Size Inches | Minimum Space Between Conduit Opening Centerlines in Millimeters (Inches) |             |             |              |              |              |              |              |              |              |
|---------------------|---|-------------|-------------|--------------|--------------|--------------|--------------|--------------|--------------|--------------|
|                     | 1/2   | 3/4         | 1           | 1-1/4        | 1-1/2        | 2            | 2-1/2        | 3            | 3-1/2        | 4            |
| 1/2                 | 31.8 (1.25)   |             |             |              |              |              |              |              |              |              |
| 3/4                 | 35.1 (1.38)   | 38.1 (1.50) |             |              |              |              |              |              |              |              |
| 1                   | 39.6 (1.56)   | 42.9 (1.69) | 47.8 (1.88) |              |              |              |              |              |              |              |
| 1-1/4               | 47.8 (1.88)   | 50.8 (2.00) | 55.6 (2.19) | 62.0 (2.44)  |              |              |              |              |              |              |
| 1-1/2               | 50.8 (2.00)   | 54.1 (2.13) | 58.7 (2.31) | 66.8 (2.63)  | 69.9 (2.75)  |              |              |              |              |              |
| 2                   | 60.5 (2.38)   | 63.5 (2.50) | 68.3 (2.69) | 74.7 (2.94)  | 79.5 (3.13)  | 87.4 (3.44)  |              |              |              |              |
| 2-1/2               | 63.5 (2.50)   | 66.8 (2.63) | 71.4 (2.81) | 79.5 (3.13)  | 82.6 (3.25)  | 92.2 (3.63)  | 95.3 (3.75)  |              |              |              |
| 3                   | 73.2 (2.88)   | 76.2 (3.00) | 81.0 (3.19) | 87.4 (3.44)  | 92.2 (3.63)  | 100.1 (3.94) | 104.9 (4.13) | 112.8 (4.44) |              |              |
| 3-1/2               | 79.5 (3.13)   | 82.6 (3.25) | 87.4 (3.44) | 95.3 (3.75)  | 98.6 (3.88)  | 108.0 (4.25) | 111.3 (4.38) | 120.7 (4.75) | 127.0 (5.00) |              |
| 4                   | 87.4 (3.44)   | 90.4 (3.56) | 95.3 (3.75) | 103.1 (4.06) | 106.4 (4.19) | 115.8 (4.56) | 119.1 (4.69) | 128.5 (5.06) | 134.9 (5.31) | 143.0 (5.63) |

# GUBB Blank Body Cast Junction Boxes

## Explosionproof, Dust-Ignitionproof

Drilling and tapping ordering information.

**NEC/CEC:**

Class I, Division 1 and 2, Groups B, C, D

Class II, Division 1 and 2, Groups E, F, G

Class III

NEMA 3, 3R, 4, 7BCD, 9EFG

### Diameters of Bushings, Unions, Conduit and Seals (in Millimeters (Inches))

| Conduit Size Inches  | Diameters of fittings for 1/2 through 4" conduit |             |             |             |             |             |              |              |              |              |
|----------------------|--|-------------|-------------|-------------|-------------|-------------|--------------|--------------|--------------|--------------|
|                      | 1/2  | 3/4         | 1           | 1-1/4       | 1-1/2       | 2           | 2-1/2        | 3            | 3-1/2        | 4            |
| BBU Bushing          | 26.9 (1.06)                                      | 33.3 (1.31) | 39.6 (1.56) | 49.3 (1.94) | 55.6 (2.19) | 68.3 (2.69) | 81.0 (3.19)  | 98.6 (3.88)  | 111.3 (4.38) | 124.0 (4.88) |
| BU Bushing           | 28.7 (1.13)                                      | 31.8 (1.25) | 41.4 (1.63) | 52.3 (2.06) | 58.7 (2.31) | 74.7 (2.94) | 82.6 (3.25)  | 98.6 (3.88)  | 115.8 (4.56) | 128.5 (5.06) |
| UNY-UNF (R) Union    | 38.1 (1.50)                                      | 44.5 (1.75) | 50.8 (2.00) | 71.4 (2.81) | 77.7 (3.06) | 95.3 (3.75) | 125.5 (4.94) | 138.2 (5.44) | 150.9 (5.94) | 165.1 (6.50) |
| Conduit              | 22.4 (0.88)                                      | 26.9 (1.06) | 35.1 (1.38) | 42.9 (1.69) | 49.3 (1.94) | 60.5 (2.38) | 73.2 (2.88)  | 88.9 (3.50)  | 101.6 (4.00) | 114.3 (4.50) |
| EYM-EYF Seals T.R. ① | 26.9 (1.06)                                      | 30.2 (1.19) | 35.1 (1.38) | 44.5 (1.75) | 52.3 (2.06) | 58.7 (2.31) | 68.3 (2.69)  | 79.5 (3.13)  | 87.4 (3.44)  | 93.7 (3.69)  |

### Wall Thickness and Maximum Conduit Size (in Millimeters (Inches))

| Box Type          | Top, Bottom and Sides |                      | Back           |                      |
|-------------------|-----------------------|----------------------|----------------|----------------------|
|                   | Wall Thickness        | Maximum Conduit Size | Wall Thickness | Maximum Conduit Size |
| GUBB-11, GUBB-11A | 11.2 (0.44)           | 2                    | 11.2 (0.44)    | 2                    |
| GUBB-22, GUBB-22A | 11.2 (0.44)           | 2                    | 16.0 (0.63)    | 4                    |
| GUBB-33, GUBB-33A | 16.0 (0.63)           | 2                    | 20.6 (0.81)    | 4                    |

① T.R. is turning radius.

# GUBB Cast Junction Boxes for Drilling and Tapping

## Explosionproof, Dust-Ignitionproof

Drilled and tapped openings from 1/2" thru 4" as specified.

### NEC/CEC:

Class I, Division 1 and 2, Groups B♦, C♦, D

Class II, Division 1 and 2, Groups E, F, G

Class III

NEMA 3, 3R, 4, 7BCD, 9EFG

|   | Size L x W x D<br>mm (in)                       | Cover Opening<br>mm (in) | Form<br>Number | Volume<br>dm <sup>3</sup> (in <sup>3</sup> ) | Catalog Number   |                 |
|---|---|--------------------------|----------------|--|------------------|-----------------|
|   |   |                          |                |  | Malleable Iron ① | Aluminum ①      |
|  | 177.8 x 165.1 x 171.5<br>(7.00 x 6.50 x 6.75)   | 136.7 (5.38)             | 1              | 2.0<br>(120)                                 | <b>GUBB-11</b>   | <b>GUBB-11A</b> |
|   | 254.0 x 203.2 x 174.8<br>(10.00 x 8.00 x 6.88)  | 182.6 (7.19)             | 2              | 3.7<br>(224)                                 | <b>GUBB-22</b>   | <b>GUBB-22A</b> |
|   | 304.8 x 304.8 x 196.9<br>(12.00 x 12.00 x 7.75) | 246.1 (9.69)             | 3              | 7.5<br>(455)                                 | <b>GUBB-33</b>   | <b>GUBB-33A</b> |

### Class I, Division 1 Sealing Requirements

| Box  | Group  | Seals Required ♦ |
|------|--------|------------------|
| GUBB | B, C ♦ | Yes              |
| GUBB | D      | No               |

| Catalog Number | Mounting Lugs |
|----------------|---------------|
| GUBB-11, 11A   | 2             |
| GUBB-22, 22A   | 2             |
| GUBB-33, 33A   | 4             |

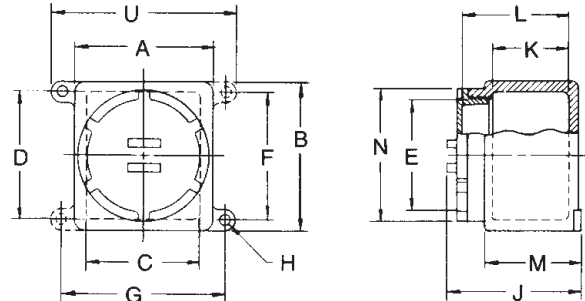

| Catalog Number | Dimensions in Millimeters (Inches) |         |         |         |        |         |         |        |        |                |        |        |         |         |
|----------------|------------------------------------|---------|---------|---------|--------|---------|---------|--------|--------|----------------|--------|--------|---------|---------|
|                | A                                  | B       | C       | D       | E      | F       | G       | H      | J      | K <sup>②</sup> | L      | M      | N       | U       |
| GUBB-11        | 165.1                              | 177.8   | 139.7   | 150.9   | 163.7  | 152.4   | 196.9   | 12.7   | 171.5  | 93.7           | 133.4  | 117.6  | 158.8   | 222.3   |
| GUBB-11A       | (6.50)                             | (7.00)  | (5.50)  | (5.94)  | (5.38) | (6.00)  | (7.75)  | (0.50) | (6.75) | (3.69)         | (5.25) | (4.63) | (6.25)  | (8.75)  |
| GUBB-22        | 203.2                              | 254.0   | 181.1   | 228.6   | 182.6  | 228.6   | 235.0   | 12.7   | 174.8  | 88.9           | 133.4  | 117.6  | 203.2   | 260.4   |
| GUBB-22A       | (8.00)                             | (10.00) | (7.13)  | (9.00)  | (7.19) | (9.00)  | (9.25)  | (0.50) | (6.88) | (3.50)         | (5.25) | (4.63) | (8.00)  | (10.25) |
| GUBB-33        | 304.8                              | 304.8   | 273.1   | 273.1   | 246.1  | 254.0   | 333.5   | 16.0   | 196.9  | 100.0          | 146.1  | 136.7  | 279.4   | 365.3   |
| GUBB-33A       | (12.00)                            | (12.00) | (10.75) | (10.75) | (9.69) | (10.00) | (13.13) | (0.63) | (7.75) | (3.94)         | (5.75) | (5.38) | (11.00) | (14.38) |

① Malleable iron and aluminum boxes furnished with aluminum cover.

② Inside dimensions.

♦ Sealing fitting must be installed within 2" of each conduit entrance (max. conduit for Group B and C is 2"). Seals not required in Class I, Division 2 areas provided there are no arcing or sparking devices in the box.

# GUBBM Instrument Enclosures



## Explosionproof, Dust-Ignitionproof

GUBBM: Furnished with one 3/4" threaded conduit opening. Aluminum body with aluminum/glass cover.

**NEC/CEC:**

Class I, Division 1 and 2, Group D  
 Class II, Division 1 and 2, Groups E, F, G  
 Class III  
 NEMA 3, 3R, 4

ENCLOSURES AND JUNCTION BOXES: NEC/CEC EXPLOSIONPROOF ENCLOSURES

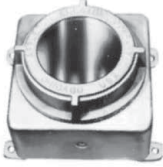
|   | Type Box | Conduit Opening Size<br>(Inches-NPT) | Cover Opening<br>mm (in) | Wall Thickness<br>mm (in) | Form<br>Number | Catalog Number  |
|---|----------|--------------------------------------|--------------------------|---------------------------|----------------|-----------------|
|  | GUBB-11A | 3/4                                  | 136.7 (5.38)             | 11.2 (0.44)               | 1              | <b>GUBBM-1A</b> |
|  | GUBB-22A | 3/4                                  | 182.6 (7.19)             | 11.2 (0.44)               | 2              | <b>GUBBM-2A</b> |
|  | GUBB-33A | 3/4                                  | 246.1 (9.69)             | 14.2 (0.56)               | 3              | <b>GUBBM-3A</b> |

Other drilled and tapped conduit opening arrangements and sizes available in addition to the one 3/4" conduit opening provided.

GUBB Cast Junction Boxes for Drilling and Tapping Blank Body Ordering Information

For Covers and Mounting Plates, Order from GUBB Surface and Special Purpose Covers page.

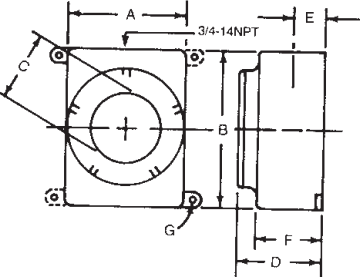
|   | Type Box | Mounting<br>Lugs | Dimensions in Millimeters (Inches) |                  |                 |                 |                |                 |                |
|---|----------|------------------|------------------------------------|------------------|-----------------|-----------------|----------------|-----------------|----------------|
|   |          |                  | A                                  | B                | C               | D               | E              | F               | G              |
|  | GUBBM-1A | 2                | 165.1<br>(6.50)                    | 177.8<br>(7.00)  | 79.5<br>(3.13)  | 143.0<br>(5.63) | 52.3<br>(2.06) | 117.6<br>(4.63) | 12.7<br>(0.50) |
|   | GUBBM-2A | 2                | 203.2<br>(8.00)                    | 254.0<br>(10.00) | 120.7<br>(4.75) | 143.0<br>(5.63) | 52.3<br>(2.06) | 117.6<br>(4.63) | 12.7<br>(0.50) |
|   | GUBBM-3A | 4                | 304.8<br>(12.00)                   | 304.8<br>(12.00) | 174.8<br>(6.88) | 227.1<br>(8.94) | 88.9<br>(3.50) | 136.7<br>(5.38) | 16.0<br>(0.63) |

Appleton



# GUBBD Cast Boxes With Dome Cover and Mounting Plate

## Explosionproof, Dust-Ignitionproof

Malleable iron junction boxes furnished with aluminum cover. For drilling and tapping.

**NEC/CEC:**

Class I, Division 1 and 2, Group D  
 Class II, Division 1 and 2, Groups E, F, G  
 Class III  
 NEMA 3, 3R, 4

|  | Nominal Cover Depth<br>mm (in) | Width of Mounting Plate<br>mm (in) | Adjustment<br>mm (in) ① | Form Number | Catalog Number |
|--|--------------------------------|------------------------------------|-------------------------|-------------|----------------|
| <br>Cover removed,<br>showing mounting<br>plate | 254.0 (10.00)                  | 88.9 (3.50)                        | 25.4 (1.00)             | 1           | GUBBD-1-10     |
|  | 152.4 (6.00)                   |                                    |                         |             | GUBBD-2-6      |
| <br>Body with<br>dome cover                     | 304.8 (12.00)                  | 124.0 (4.88)                       | 38.1 (1.50)             | 2           | GUBBD-2-12     |
|  | 152.4 (6.00)                   |                                    |                         |             | GUBBD-3-6      |
|  | 304.8 (12.00)                  | 158.8 (6.25)                       | 54.1 (2.13)             | 3           | GUBBD-3-12     |
|  | 431.8 (17.00)                  |                                    |                         |             | GUBBD-3-17     |

**Dimensions in Millimeters (Inches)**

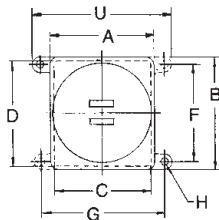

GUBBD-1 (2 Lugs), GUBBD-2 (2 Lugs), GUBBD-3 (4 Lugs)

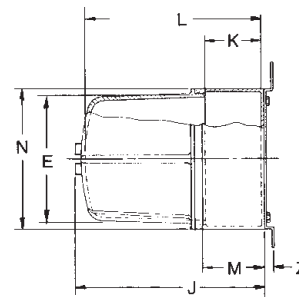

All Types

| Catalog Number | Dimensions in Millimeters (Inches) |                  |                  |                  |                 |                  |                  |                |                  |                 |                  |                 |                 |                  |
|----------------|------------------------------------|------------------|------------------|------------------|-----------------|------------------|------------------|----------------|------------------|-----------------|------------------|-----------------|-----------------|------------------|
|                | A                                  | B                | C ②              | D ②              | E               | F                | G                | H              | J                | K ②             | L ②              | M               | N               | U                |
| GUBBD-1-10     | 165.1<br>(6.50)                    | 177.8<br>(7.00)  | 153.9<br>(6.06)  | 166.6<br>(6.56)  | 136.7<br>(5.38) | 152.4<br>(6.00)  | 196.9<br>(7.75)  | 12.7<br>(0.50) | 409.7<br>(16.13) | 95.3<br>(3.75)  | 374.7<br>(14.75) | 117.6<br>(4.63) | 41.0<br>(1.61)  | 222.3<br>(8.75)  |
| GUBBD-2-6      | 203.2<br>(8.00)                    | 254.0<br>(10.00) | 192.0<br>(7.56)  | 242.8<br>(9.56)  | 182.6<br>(7.19) | 228.6<br>(9.00)  | 235.0<br>(9.25)  | 12.7<br>(0.50) | 309.6<br>(12.19) | 96.8<br>(3.81)  | 273.1<br>(10.75) | 117.6<br>(4.63) | 77.1<br>(3.04)  | 260.4<br>(10.25) |
| GUBBD-2-12     | 203.2<br>(8.00)                    | 254.0<br>(10.00) | 192.0<br>(7.56)  | 242.8<br>(9.56)  | 182.6<br>(7.19) | 228.6<br>(9.00)  | 235.0<br>(9.25)  | 12.7<br>(0.50) | 462.0<br>(18.19) | 96.8<br>(3.81)  | 425.5<br>(16.75) | 117.6<br>(4.63) | 77.1<br>(3.04)  | 260.4<br>(10.25) |
| GUBBD-3-6      | 304.8<br>(12.00)                   | 304.8<br>(12.00) | 289.1<br>(11.38) | 289.1<br>(11.38) | 246.1<br>(9.69) | 254.0<br>(10.00) | 333.5<br>(13.13) | 16.0<br>(0.63) | 350.8<br>(13.81) | 111.3<br>(4.38) | 293.6<br>(11.56) | 136.7<br>(5.38) | 125.2<br>(4.93) | 365.3<br>(14.38) |
| GUBBD-3-12     | 304.8<br>(12.00)                   | 304.8<br>(12.00) | 289.1<br>(11.38) | 289.1<br>(11.38) | 246.1<br>(9.69) | 254.0<br>(10.00) | 333.5<br>(13.13) | 16.0<br>(0.63) | 503.2<br>(19.81) | 111.3<br>(4.38) | 446.0<br>(17.56) | 136.7<br>(5.38) | 125.2<br>(4.93) | 365.3<br>(14.38) |
| GUBBD-3-17     | 304.8<br>(12.00)                   | 304.8<br>(12.00) | 289.1<br>(11.38) | 289.1<br>(11.38) | 246.1<br>(9.69) | 254.0<br>(10.00) | 333.5<br>(13.13) | 16.0<br>(0.63) | 642.9<br>(25.31) | 111.3<br>(4.38) | 585.7<br>(23.06) | 136.7<br>(5.38) | 125.2<br>(4.93) | 365.3<br>(14.38) |

① Mounting plate is adjustable. May be centered or located to one side.

② Inside dimensions.

# GUBB/GUBBD/GUBBM Cast Junction Box Covers



## Explosionproof, Dust-Ignitionproof

Covers provide raintight fit when used with O-rings. Available in malleable iron, aluminum, and aluminum/glass.

### NEC/CEC:

Class I, Division 1 and 2, Group D  
 Class II, Division 1 and 2, Groups E, F, G  
 Class III  
 NEMA 3, 3R, 4

ENCLOSURES AND JUNCTION BOXES: NEC/CEC EXPLOSIONPROOF ENCLOSURES

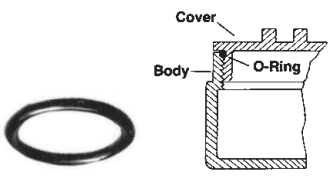
|  |   | Fits Box<br>Catalog Number | Nominal Cover<br>Depth<br>mm (in) | Nominal Cover<br>Diameter<br>mm (in) | Window<br>Diameter<br>mm (in) | Form<br>Number | Catalog<br>Number |
|--|---|----------------------------|-----------------------------------|--------------------------------------|-------------------------------|----------------|-------------------|
| <b>Covers — Aluminum — O-ring Gasket Included</b>  |   |                            |                                   |                                      |                               |                |                   |
|  <p>GUBK-1, GUBK-2      GUBK-3</p>    | GUBB-11 (11A)   |                            | Surface                           | 136.7 (5.38)                         | 53.8 (2.12)                   | 1              | <b>GUBK-1</b>     |
|  | GUBB-22 (22A)   |                            | Surface                           | 182.6 (7.19)                         | 120.7 (4.75)                  | 2              | <b>GUBK-2</b>     |
|  | GUBB-33 (33A)   |                            | Surface                           | 246.1 (9.69)                         | 177.8 (7.00)                  | 3              | <b>GUBK-3</b>     |
| <b>Instrument Box Covers — Aluminum and Glass</b>  |   |                            |                                   |                                      |                               |                |                   |
|  <p>GUBMK-1, GUBMK-2      GUBMK-3</p> | GUBB-11 (11A)   |                            | —                                 | 136.7 (5.38)                         |                               | 1              | <b>GUBMK-1</b>    |
|  | GUBB-22 (22A)   |                            | —                                 | 182.6 (7.19)                         |                               | 2              | <b>GUBMK-2</b>    |
|  | GUBB-33 (33A)   |                            | —                                 | 246.1 (9.69)                         |                               | 3              | <b>GUBMK-3</b>    |
| <b>Dome Covers for GUBB Boxes — Aluminum — O-ring Gasket Included</b>  |   |                            |                                   |                                      |                               |                |                   |
|                                      | GUBB-11 (11A)   |                            | 254.0 (10.00)                     | 136.7 (5.3)                          |                               | 1              | <b>GUBK-1-10</b>  |
|  | GUBB-22 (22A)   |                            | 152.4 (6.00)                      | 182.6 (7.19)                         |                               | 2              | <b>GUBK-2-6</b>   |
|  | GUBB-22 (22A)   |                            | 304.8 (12.00)                     | 182.6 (7.19)                         |                               | 2              | <b>GUBK-2-12</b>  |
|  | GUBB-33 (33A)   |                            | 152.4 (6.00)                      | 246.1 (9.69)                         |                               | 3              | <b>GUBK-3-6</b>   |
|  | GUBB-33 (33A)   |                            | 304.8 (12.00)                     | 246.1 (9.69)                         |                               | 3              | <b>GUBK-3-12</b>  |
|  | GUBB-33 (33A)   |                            | 431.8 (17.00)                     | 246.1 (9.69)                         |                               | 3              | <b>GUBK-3-17</b>  |
| <b>Replacement O-rings — Neoprene</b>  |   |                            |                                   |                                      |                               |                |                   |
|                                     | Provide raintight fit for GUBB, GUBBM and GUBBD Boxes |                            |                                   |                                      |                               |                |                   |
|  | GUBB-11 (11A)   |                            |                                   |                                      |                               | 1              | <b>GUBG-1</b>     |
|  | GUBB-22 (22A)   |                            |                                   |                                      |                               | 2              | <b>GUBG-2</b>     |
|  | GUBB-33 (33A)   |                            |                                   |                                      |                               | 3              | <b>GUBG-3</b>     |
| <b>Mounting Plates — 3.3 mm (0.13") Thick Aluminum. 4 standoffs, 4 mounting screws</b>                                 |   |                            |                                   |                                      |                               |                |                   |
|  | GUBB-11 (11A) ①                                       |                            |                                   | 114.3 x 114.3<br>(4.50 x 4.50)       |                               | 1              | <b>GUBBMP-11</b>  |
|  | GUBB-22 (22A) ①                                       |                            |                                   | 165.1 x 165.1<br>(6.50 x 6.50)       |                               | 2              | <b>GUBBMP-22</b>  |
|  | GUBB-33 (33A) ①                                       |                            |                                   | 228.6 x 228.6<br>(9.00 x 9.00)       |                               | 3              | <b>GUBBMP-33</b>  |

① GUBB boxes are Pre-Drilled to accept a mounting plate.